

INSET
SCALE: 1"=30'

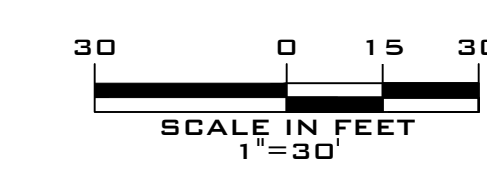

LEGEND

- | | |
|---|--|
| <ul style="list-style-type: none"> □ CONC. MONUMENT ○ IRON PIN ● BOLLARD ○ CLEANOUT ⊕ FIRE HYDRANT ⊕ GAS VALVE ⊕ GUP WIRE ⊕ 1" INLET ⊕ 2" INLET ⊕ 3" INLET ○ LIGHT POLE ○ MAILBOX ○ SANITARY MANHOLE ○ SIGN ○ SPOT ELEVATION ○ STORM MANHOLE ○ TREE ○ UNKNOWN MANHOLE ○ UTILITY POLE ○ UTILITY POLE W/LIGHT ○ WATER METER ○ ELEC. TRANSFORMER | <ul style="list-style-type: none"> --- 1' CONTOUR INTERVAL --- 5' CONTOUR INTERVAL --- CURB --- EDGE OF PAVEMENT --- EDGE OF STONE --- CHAIN LINK FENCE --- VINYL FENCE --- WIRE FENCE --- WOOD FENCE --- GAS LINE --- PROPERTY LINE --- STORM LINE --- SANITARY LINE --- WOODS LINE --- LIMIT OF DISTURBANCE |
|---|--|

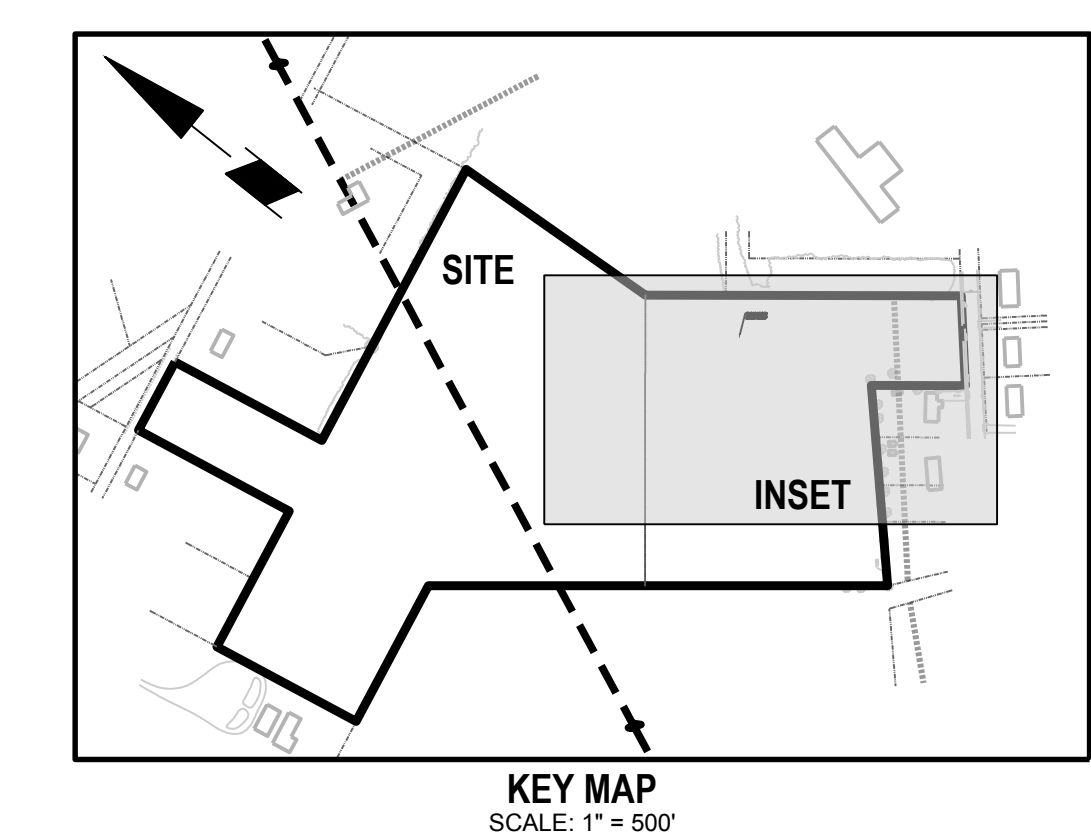

DEMOLITION PLAN

SITE PLANS
 FOR
FIRST BAPTIST CHURCH OF ELMER
 PLATE 6, BLOCK 12, LOTS 2.10 & 2.12
 329 FRONT STREET
 SITUATED IN THE
BOROUGH OF ELMER
 COUNTY OF SALEM, STATE OF NEW JERSEY
SITE CIVIL ENGINEERING
 2205 DELSEA DRIVE, SUITE 7
 FRANKLINVILLE, NEW JERSEY 08322
 (908) 885-8679
 FAX (908) 513-6504
 N.J. CERTIFICATE OF AUTHORIZATION No. GA28188600

FILE NUMBER 934-2021	CHECKED BY: WG	DATE 11/09/22					
DRAWN BY: MPG	 WILLIAM P. GILMORE, P.E. NEW JERSEY PROFESSIONAL ENGINEER NO. 2460472100						
REV.	DATE	DESCRIPTION	BY	SCALE: 1"=30'	PROJECT NO. 934	DATE: NOVEMBER 9, 2022	SHEET 3 OF 12