

DATE	REVISED BY	LIC. No.
DEC. 86	ALLAN M. KAMMERER	12633
AUG. 88	ALLAN M. KAMMERER	12633
NOV. 92	ALLAN M. KAMMERER	12633
DEC. 02	JOHN SCHWEPPEHEISER JR.	24190
APR. 05	JOHN SCHWEPPEHEISER JR.	24190
DEC. 06	JOHN SCHWEPPEHEISER JR.	24190
JULY 07	JOHN SCHWEPPEHEISER JR.	24190
NOV. 07	JOHN SCHWEPPEHEISER JR.	24190

SHEET 4

MATCH LINE

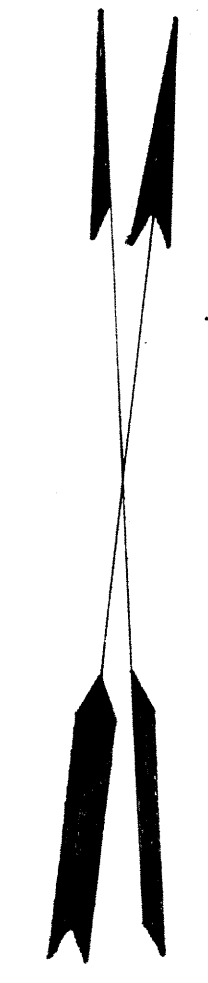
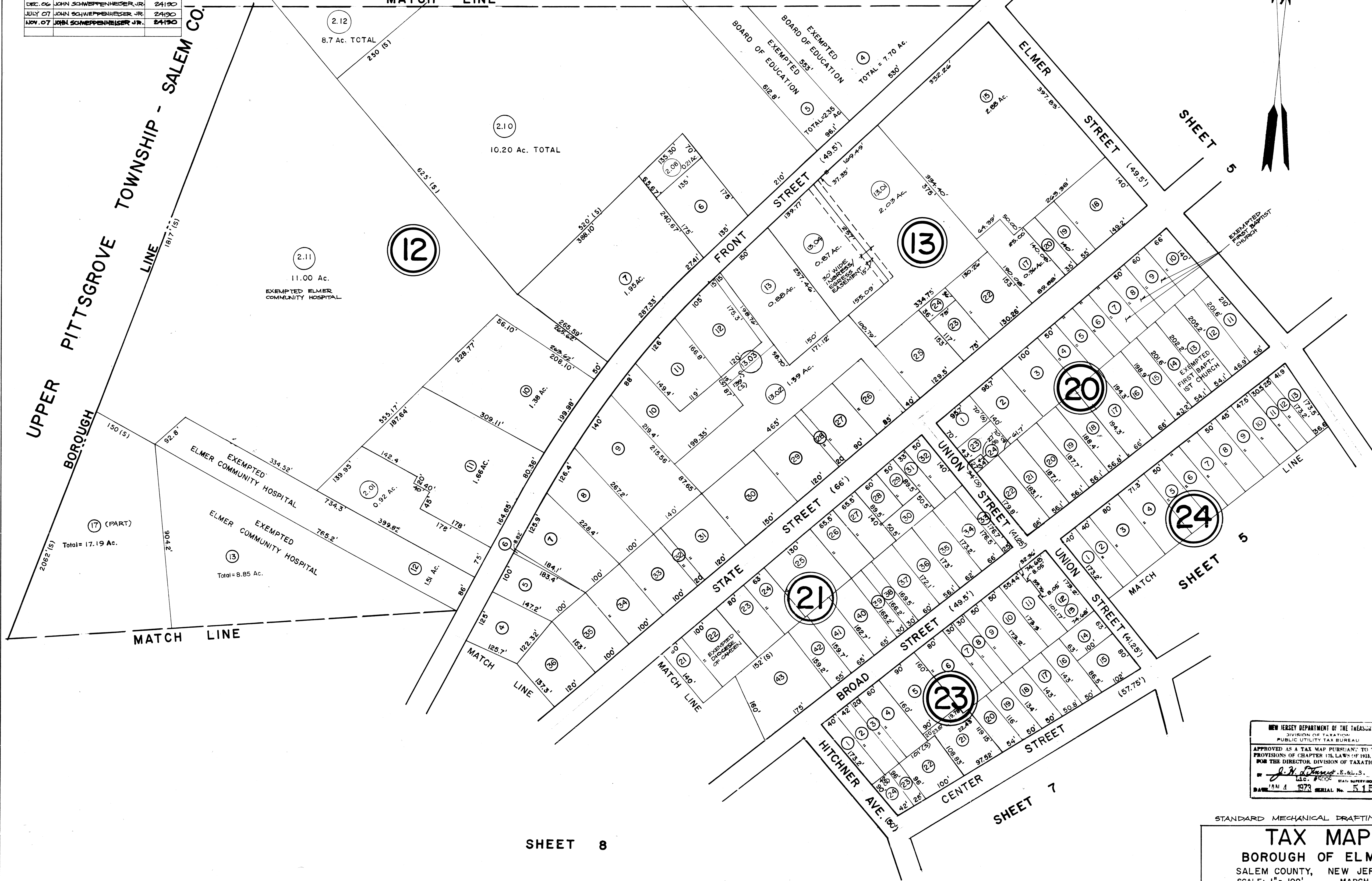

NEW JERSEY DEPARTMENT OF THE TREASURY
 DIVISION OF TAXATION
 PUBLIC UTILITY TAX BUREAU
 APPROVED AS A TAX MAP PURSUANT TO THE
 PROVISIONS OF CHAPTER 175, LAWS OF 1911, ETC.
 BY THE DIRECTOR, DIVISION OF TAXATION.
J. H. Adams S.E., S.
 L.I.C. # 4508 STATE SUPERVISOR
 DATE: JAN 4 1973 SERIAL No. 515

STANDARD MECHANICAL DRAFTING 2006

TAX MAP
 BOROUGH OF ELMER
 SALEM COUNTY, NEW JERSEY
 SCALE: 1" = 100'
 MARCH 1972
 REV. NOV. 1976
 REV. DEC. 1980

SHEET 8

SHEET 7

SHEET 5

SHEET 5