

DATE	REVISED BY	L.I.C. No.
AUG. 88	ALLAN M. KAMMERER	12633
JAN. 91	ALLAN M. KAMMERER	12633
NOV. 92	ALLAN M. KAMMERER	12633
DEC. 94	JOHN SCHWEPPEHEISER	24190
DEC. 00	JOHN SCHWEPPEHEISER	24190
JAN. 04	JOHN SCHWEPPEHEISER JR.	24190
APR. 05	JOHN SCHWEPPEHEISER JR.	24190
DEC. 06	JOHN SCHWEPPEHEISER JR.	24190
JULY 07	JOHN SCHWEPPEHEISER JR.	24190
JAN. 19	ADAM R. GRANT	43357

BLOCK 16, LOT 12 UNASSIGNED

SHEET 1

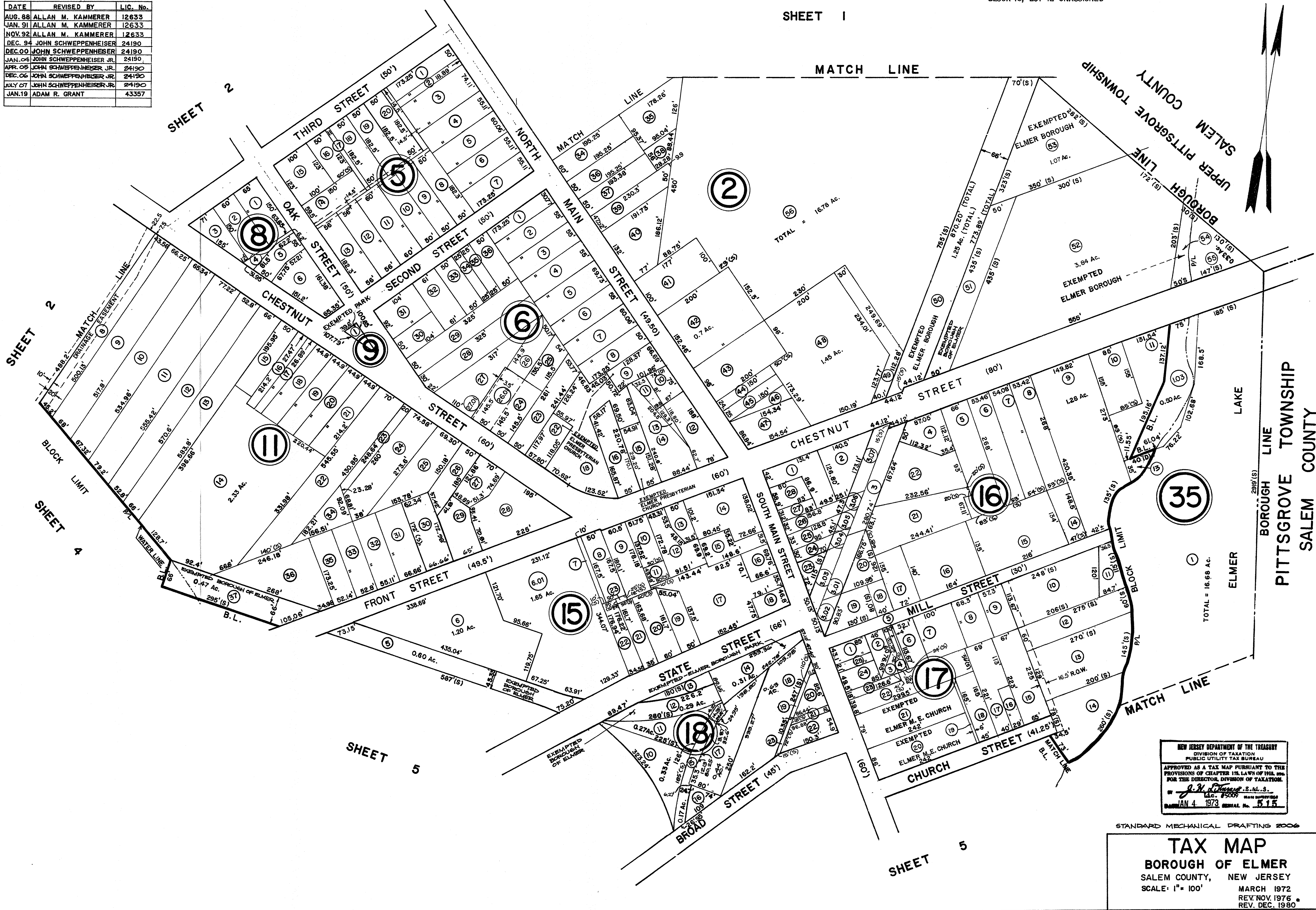
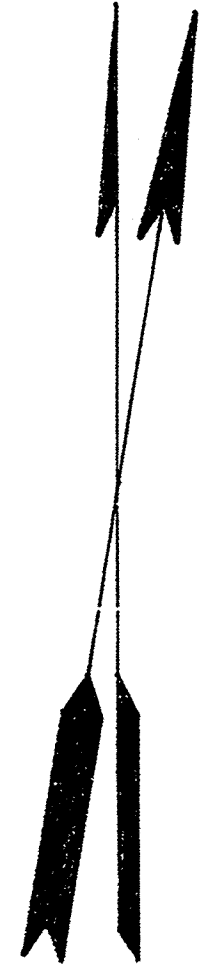

NEW JERSEY DEPARTMENT OF THE TREASURY  
 DIVISION OF TAXATION  
 PUBLIC UTILITY TAX BUREAU  
 APPROVED AS A TAX MAP PURSUANT TO THE  
 PROVISIONS OF CHAPTER 124, LAWS OF 1972  
 FOR THE DIRECTOR, DIVISION OF TAXATION.  
*J. M. [Signature]*, S. L. S.  
 L.I.C. 12609  
 JAN 4, 1973 SERIAL No. 515

STANDARD MECHANICAL DRAFTING 2006

**TAX MAP**  
**BOROUGH OF ELMER**  
 SALEM COUNTY, NEW JERSEY  
 SCALE: 1" = 100'      MARCH 1972  
 REV. NOV. 1976      REV. DEC. 1980

P:\Projects\3677-04\dwg\survey\PLATES.dwg, Layout1, 2/19/2019 10:38:02 AM, mmm, 1:1