

DATE	REVISED BY	LIC. No.
AUG. 88	ALLAN M. KAMMERER	12633
DEC. 91	ALLAN M. KAMMERER	12633
NOV. 92	ALLAN M. KAMMERER	12633
DEC. 93	ALLAN M. KAMMERER	12633
DEC. 94	JOHN SCHWEPPEHEISER	24190
DEC. 95	JOHN SCHWEPPEHEISER	24190
DEC. 96	JOHN SCHWEPPEHEISER	24190
NOV. 97	JOHN SCHWEPPEHEISER	24190
DEC. 99	JOHN SCHWEPPEHEISER	24190
DEC. 00	JOHN SCHWEPPEHEISER	24190
JAN. 04	JOHN SCHWEPPEHEISER JR.	24190
APR. 05	JOHN SCHWEPPEHEISER JR.	24190
DEC. 06	JOHN SCHWEPPEHEISER JR.	24190
NOV. 07	JOHN SCHWEPPEHEISER JR.	24190
DEC. 08	JOHN SCHWEPPEHEISER JR.	24190
DEC. 09	JOHN SCHWEPPEHEISER JR.	24190
DEC. 2012	CARL R. GASKILL	24598
DEC. 2013	CARL R. GASKILL	24598
DEC. 2014	CARL R. GASKILL	24598
DEC. 2015	CARL R. GASKILL	24598
DEC. 2016	CARL R. GASKILL	24598
DEC. 2017	CARL R. GASKILL	24598

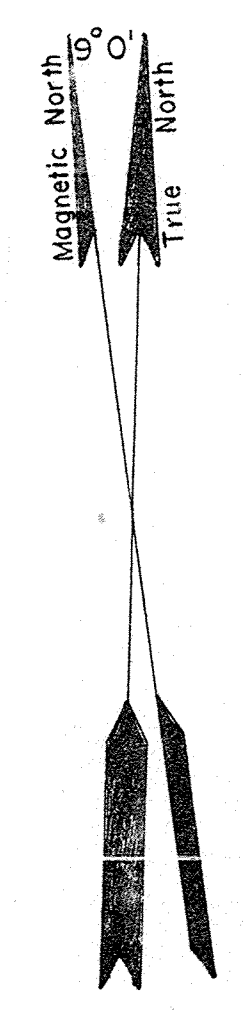
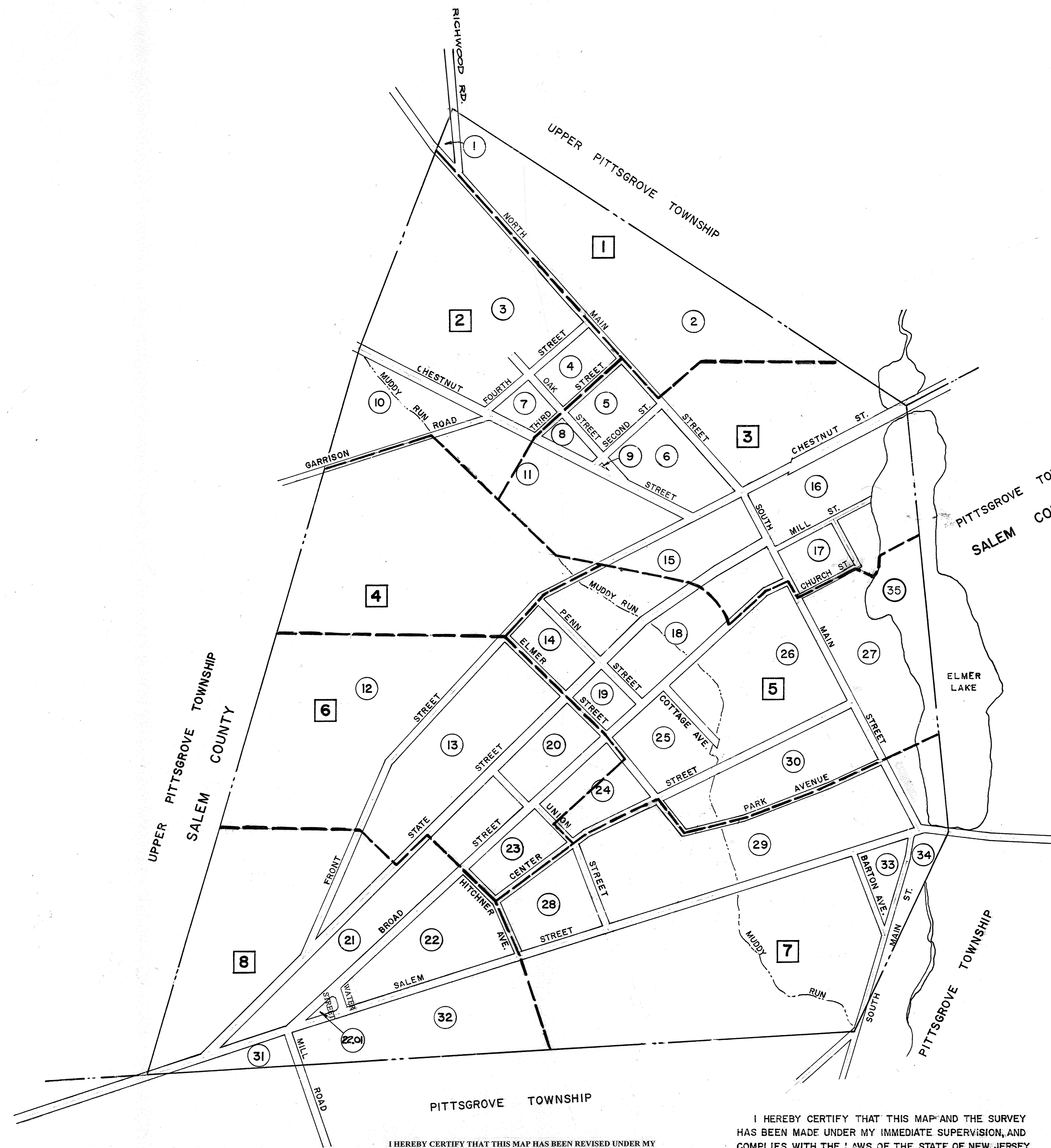

"I HEREBY CERTIFY THAT THIS MAP HAS BEEN REVISED UNDER MY IMMEDIATE SUPERVISION AND COMPLIES WITH THE LAWS OF THE STATE OF NEW JERSEY"

BY *John Schuppenheiser, Jr.*  
 KAMMERER SCHWEPPEHEISER ASSOCIATES  
 JOHN SCHWEPPEHEISER, JR.  
 NEW JERSEY LICENSE NUMBER 24190

THE AREAS, BOUNDARIES AND DIMENSIONS SHOWN ON THIS TAX MAP ARE DERIVED FROM GROUND SURVEYS, AERIAL SURVEYS, AND RECORDED PLANS, MAPS, DEEDS, AND WILLS AND ARE TO BE USED FOR ASSESSMENT PURPOSES ONLY.

**LEGEND**  
 □ SHEET NUMBER  
 ○ BLOCK NUMBER  
 - - - SHEET LIMIT

NEW JERSEY DEPARTMENT OF THE TREASURY  
 DIVISION OF TAXATION  
 PUBLIC UTILITY TAX BUREAU  
 APPROVED AS A TAX MAP PURSUANT TO THE PROVISIONS OF CHAPTER 174, LAWS OF 1972, FOR THE DIRECTOR, DIVISION OF TAXATION.  
*J. J. Demers, P.E. & L.S. #5009*  
 DATE: JAN 4 1972 SERIAL No. 515

I HEREBY CERTIFY THAT THIS MAP AND THE SURVEY HAS BEEN MADE UNDER MY IMMEDIATE SUPERVISION, AND COMPLIES WITH THE LAWS OF THE STATE OF NEW JERSEY  
*Carl R. Gaskill*  
 CARL R. GASKILL, P.E., P.L.S., LIC. #24598 P.P. LIC. #4108

I HEREBY CERTIFY THAT THIS MAP AND THE SURVEY HAS BEEN MADE UNDER MY IMMEDIATE SUPERVISION, AND COMPLIES WITH THE LAWS OF THE STATE OF NEW JERSEY  
*Harry L. Symes*  
 HARRY L. SYMES, N.J.L.S. No. 6727

STANDARD MECHANICAL DRAFTING 2005  
 TO SHOW CONDITIONS AS OF DECEMBER 2017

**TAX MAP**  
**BOROUGH OF ELMER**  
 SALEM COUNTY, NEW JERSEY  
 SCALE: 1" = 400' MARCH 1972  
 HARRY L. SYMES - N.J.L.S. No. 6727  
 SALEM - PENNSVILLE ROAD, PENNSVILLE